

Mae Gweinidogion Cymru yn ardystio drwy hyn mai hwn yw'r plan y cyfeirir ato yng Ngorchymyn Cau Priffyrdd (Ffordd Bleddyn, Ffynnon Taf, Rhondda Cynon Taf) 2024
Y Plan a Adnewydd 3
 File No/ Rhif y Ffeil: qA1481673

The Welsh Ministers Hereby Certify That This Is The Plan Referred To In The Stopping Up Of Highways (Ffordd Bleddyn, Taff's Well, Rhondda Cynon Taf) Order 2024
Deposited Plan 3
 File No: qA1481673

Dyddiedig/Dated: 17 Medi /September 2024

Nid Hunter

Nicci Hunter
 Arweinydd y Tîm Busnes / Business Team Leader
 Llywodraeth Cymru / Welsh Government

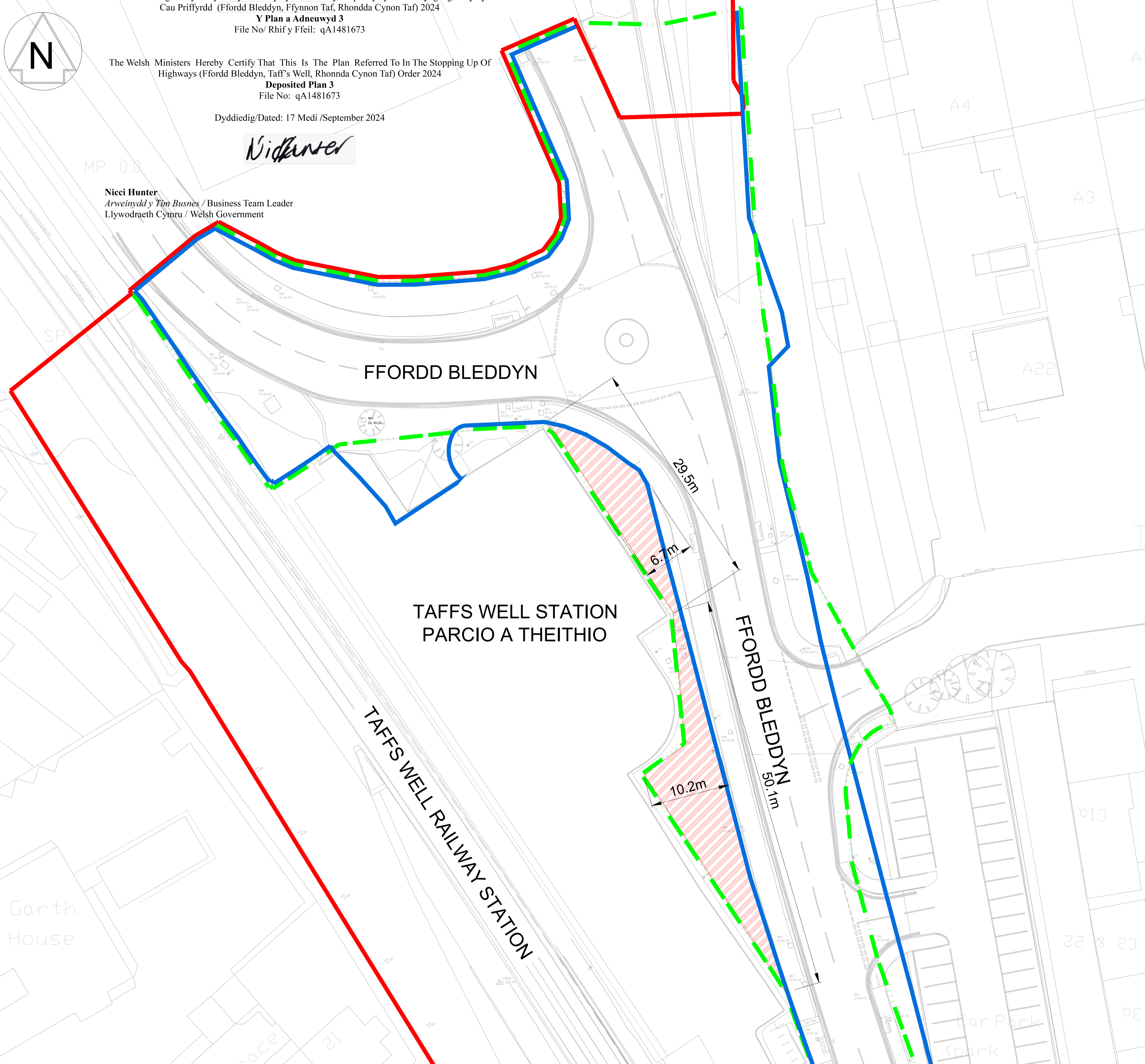

NOTES

1. Peidiwch â graddfa / Do Not Scale.
2. Pob mesuriad mewn metrau oni nodir / All measurements are in metres unless specified.

KEY

- Ffin y briffordd mabwysiadol arfaethedig / Proposed adoptable highway boundary
- Ffin y briffordd bresennol / Existing highway boundary
- Ffin y safle / Site Boundary
- Priffordd yn cael ei chau / Highway to be stopped up

| Rev | Date | Description of Revisions | Drawn | Chkd | Appr | Suitability |
|-----|----------|--------------------------|-------|------|------|-------------|
| B02 | 01/08/23 | Drawing changes | LS | SE | LM | |
| B01 | 24/05/23 | For Approval | LS | LM | AS | |

Status: **Fit for information** Suitability: **S2**

TRAFNIDIAETH CYMRU
 TRANSPORT FOR WALES

amey
 SEILWAITH INFRASTRUCTURE

| | | | | | |
|--|------------------|----------------------|----|------|------------------------|
| Authorised | - | Signed | - | Date | - |
| Contractor(s) Amey Infrastructure Wales | | | | | |
| Asset Location | Sub-Asset TRAN01 | | | | |
| Type | CAD Drawings | Sub-type DDR | | | |
| Role | D | Sub-Role HW | | | |
| Location Zone | TAF | Plan of Work Stage E | | | |
| Project TRAN01 - CVL Transformation | | | | | |
| Route Section Group Route Section Group | | | | | |
| Route Section Taffs Well Depot | | | | | |
| Drawing Title S100 Stopping Up Order 3 FFordd Bleddyn - Rail Car Park Boundary | | | | | |
| Designed | L Masters | Signed | LM | Date | 01/08/2023 |
| Drawn | L So | Signed | LS | Date | 01/08/2023 |
| Checked | S Elshafie | Signed | SE | Date | 01/08/2023 |
| Approved | L Masters | Signed | LM | Date | 01/08/2023 |
| Scale(s) Graddfa 1:500 ELR & Mileage CAM 7M 24ch to 7M 24ch | | | | | |
| Alternative Reference | | | | | Sheet |
| - | | | | | 3 of 3 |
| Drawing Number TRAN01-KAW-R0-TAF-DDR-D-HW-000343 | | | | | Revision B02 |