



Isle of Anglesey County Council  
Lead Local Flood Authority

---

# Flood Investigation Report

---

Location: XX Stad Plas Hen, Llanddaniel Fab, Anglesey LL60 6HW

Date of Flood Incident: 22<sup>nd</sup> November, 2017

Reference: YM2017S19.31

Mae'r Ddogfen hon hefyd ar gael yn Gymraeg

This Document is also available in Welsh

SWYDDOGOL SENSITIF/OFFICIAL SENSITIVE

Document Schedule

Revision Schedule

Date	Version	Details	Author	Checked by	Approved by
15.03.2018	1.0	Draft	XXXXXXXXXX	XXXXXXXXXX	XXXXXXXXXX
24.04.2018	2.0	Draft	XXXXXXXXXX	XXXXXXXXXX	XXXXXXXXXX
16.08.2018	2.0	Final	XXXXXXXXXX	XXXXXXXXXX	XXXXXXXXXX

#### Distribution

Organisation	Date	Version
XX Stad Plas Hen Llanddaniel Fab Anglesey LL60 6HW	24.04.2018	2.0
IoACC – Highways, Waste and Property	24.04.2018	2.0

#### Contents

1. Executive Summary
2. Introduction
  - 2.1 Lead Local Flood Authority – Investigation
  - 2.2 Site Location
3. Flood Risk Management Authorities (FRMA)
  - 3.1 IOACC Area – Flood Risk Management Authorities
4. Flood Investigation
  - 4.1 Flood History
  - 4.2 Flood Incident (22.11.2017)
5. Conclusion
6. Recommendations
7. Appendices
  - 7.1 Location Plan – LLANDD001
  - 7.2 Location Plan Affected area: - LLANDD002
  - 7.3 Photographs

## 1. Executive Summary

This Flood Investigation Report has been completed by Isle of Anglesey County Council under our duties as the Lead Local Flood Authority. Isle of Anglesey County Council has investigated flooding at XX, Stad Plas Hen, Llanddaniel Fab, Anglesey, as required under Section 19 of the Flood and Water Management Act 2010.

This report provides details of the investigation with recommendations and conclusions.

A copy of the report has been sent to all parties concerned with the flooding incident.

Number XX Stad Plas Hen, Llanddaniel Fab was affected by internal flooding on the 22<sup>nd</sup> November, 2018 as a result of a prolonged period of heavy rainfall.

Flood water was reportedly flooding off the adjacent estate road and into the front garden of the property, causing internal flooding to the front porch area. The dwelling is located in a low lying area at the bottom end of the estate and it would appear that the highway surface water drainage system was unable to accommodate the run-off generated by the rainfall event.

The water flooded along the estate road into the cul-de-sac and followed its natural flow path into the open fields, which evidently have a high water table and are poorly drained. Due to the relative levels of the dwelling and the surrounding ground, the flood water was partially entrapped in the garden of the property and reached a depth where it infiltrated the porch area of the building.

.

## 2. Introduction

### 2.1 Lead Local Flood Authority - Investigation

Isle of Anglesey County Council as the Lead Local Flood Authority has a responsibility to record and report flood incidents as detailed within Section 19 of the Flood and Water Management Act 2010.

#### Section 19 (FWMA)

- (1) On becoming aware of a flood in its area, a lead local flood authority must, to the extent that it considers it necessary or appropriate, investigate -
  - (a) which risk management authorities have relevant flood risk management functions, and
  - (b) whether each of those risk management authorities has exercised, or is proposing to exercise, those functions in response to the flood.
- (2) Where an authority carries out an investigation under subsection (1) it must –
  - (a) publish the results of its investigation, and
  - (b) notify any relevant risk management authorities.

### 2.2 Site Location See Appendices.

(Grid Ref: - XXXXXXXXX)

(USRN: - XXXXXXXXX)

## 3. Flood Risk Management Authorities (FRMA)

Isle of Anglesey County Council, Llangefni, Anglesey. LL77 7TW

### 3.1 IoACC Area – Flood Risk Management Authorities

- Isle of Anglesey County Council (LLFA)
- Natural Resources Wales
- Dŵr Cymru / Welsh Water (DC/WW)
- IoACC – Highways, Waste and Property
- Trunk Road Agency

## 4. Flood Investigation

### 4.1 Flood History

The Authority have no previous record of flooding incidents at XX, Stad Plas Hen, Llanddaniel Fab.

### 4.2 Flood Incident 22.11.2017

A flooding incident occurred at number XX Stad Plas Hen, Llanddaniel Fab, on the 22.11.2017 during a period of prolonged heavy rainfall.

Daily rainfall data received from the nearest Natural Resources Wales station in Afon Adda Bangor Gwynedd confirmed that approximately 92.00mm fell in a 24 hour period and this was recorded on the 22.11.2017 (Contains Natural Resources Wales information © Natural Resources Wales and database right).

The available data also indicated that peaks in rainfall intensity were recorded within this period. (19:45 hrs. – 4.8 mm in 15 mins. and 20:45 hrs – 5.2 mm in 15 mins.).

A report was received by the Highways out of hours service on the 22<sup>nd</sup> November, 2017 of flooding to the property.

The Authority Flood and Water Management Technician visited the site on the 28<sup>th</sup> February, 2018 to undertake an assessment and interview the residents.

The property is located in a cul-de-sac within a point at the far end of Stad Plas Hen and is bounded by fields at the rear, which are waterlogged with a significant amount of surface water ponding visible.

It would appear that the water flowed along the estate road into the cul-de-sac and followed its natural flow path into the open fields beyond. Due to the relative levels of the dwelling and the surrounding ground, the flood water was partially entrapped in the garden of the property and reached a depth where it infiltrated the porch area of the building.

There are road gullies located in the estate road fronting the property and an initial inspection of the system, which discharges to a land drainage ditch, revealed no obvious obstruction or blockages.

## 5. Conclusion

It is considered that, due to the duration of the rainfall event and the intense periods of rainfall associated with this episode, surface water drainage systems in the vicinity were unable to accommodate the run-off.

The flood water drained down into the cul-de-sac and overflowed through the grounds of XX, Stad Plas Hen, internally flooding the front porch area of the dwelling.

## 6. Recommendations

Flood Risk Management Authorities (FRMA) / Stakeholder	Recommended Actions	Confirmed Actions
Isle of Anglesey County Council (LLFA)	<ul style="list-style-type: none"> <li>• Facilitate sharing of information between Risk Management Authorities, and the communities.</li> <li>• Keep a record of all flooding incidents and significant flood risk assets within the area.</li> </ul>	<ul style="list-style-type: none"> <li>• Record of flooding incidents updated on InfoNet.</li> <li>• Make Residents aware of the National Flood Forum Charity</li> </ul>
IoACC – Highways, Waste and Property	<ul style="list-style-type: none"> <li>• Arrange for overhanging tree branches in neighbouring property to be cut back, to permit gully cleansing to be undertaken.</li> <li>• Investigate drainage system to ensure that drains are clear and operating satisfactorily.</li> </ul>	<ul style="list-style-type: none"> <li>• To action</li> <li>• Actioned</li> </ul>
Affected Property	<ul style="list-style-type: none"> <li><input type="checkbox"/> Residents to consider Installation of flood gates to doors of property, to increase flood resilience of dwelling.</li> </ul>	<ul style="list-style-type: none"> <li><input type="checkbox"/> To action</li> </ul>

## 7. Appendices.

## 7.1 Location Plan – LLANDD001

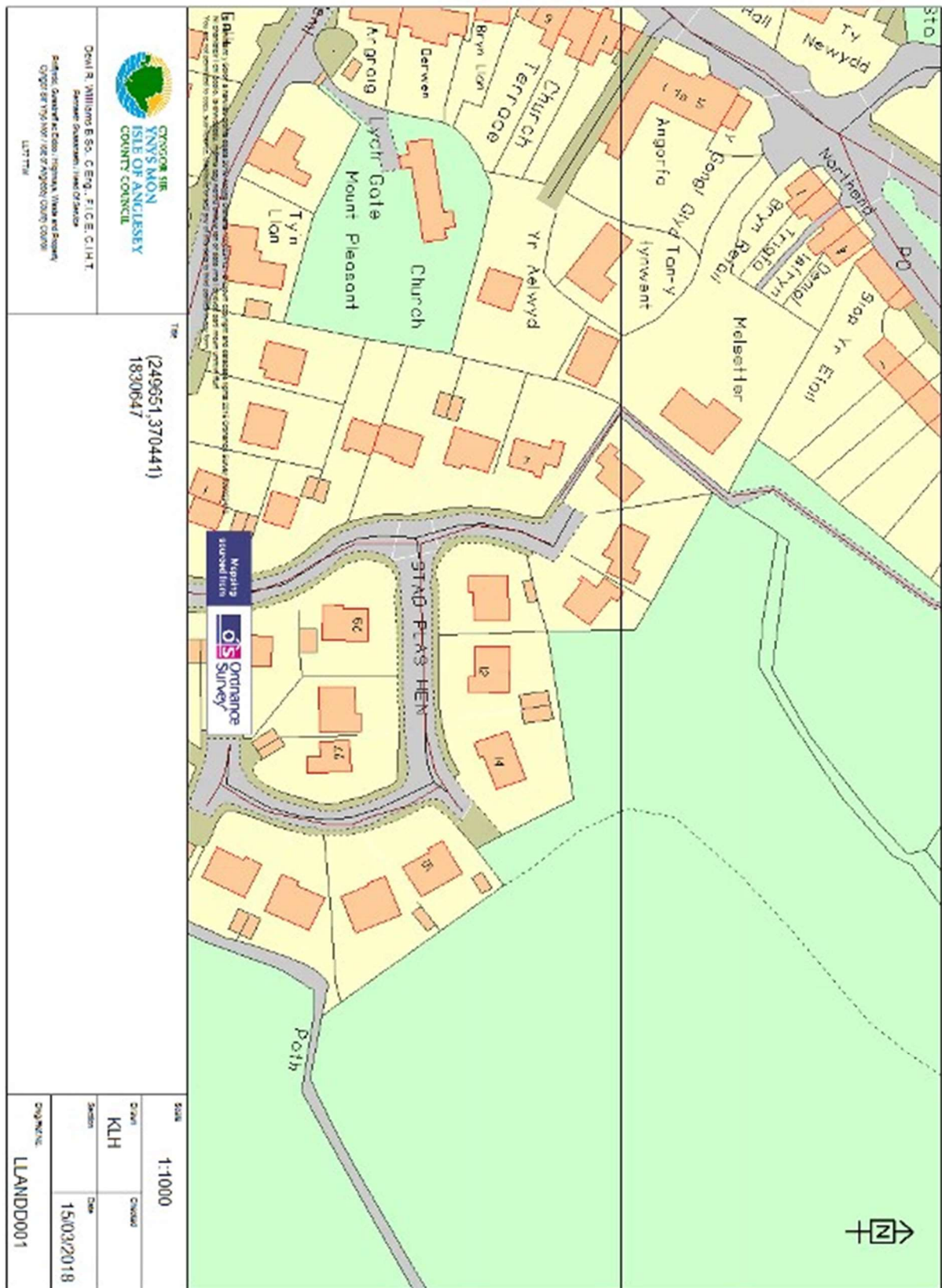

7.2 Location Plan: Affected Area – LLANDD002

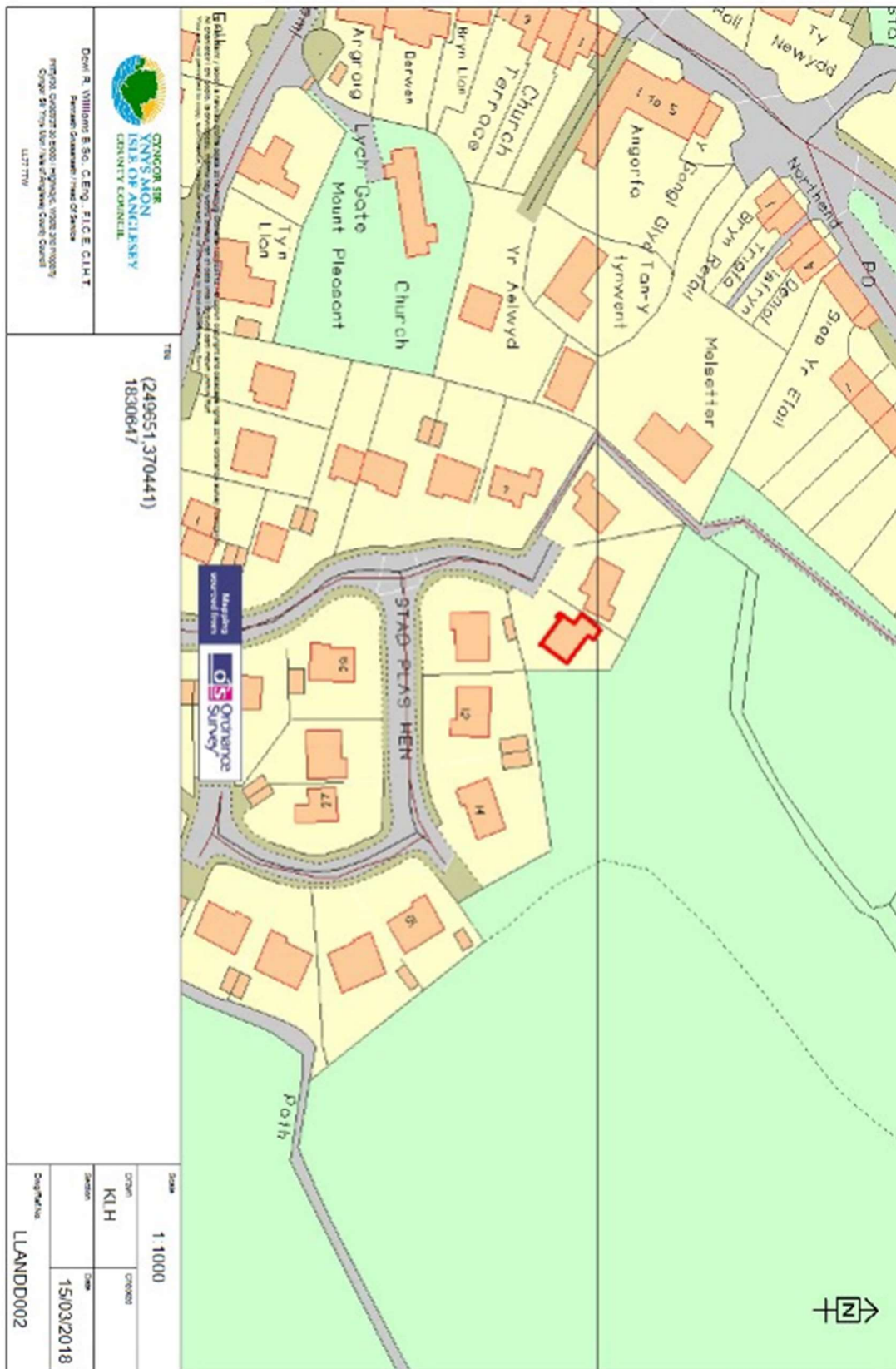

7.3 – Photographs

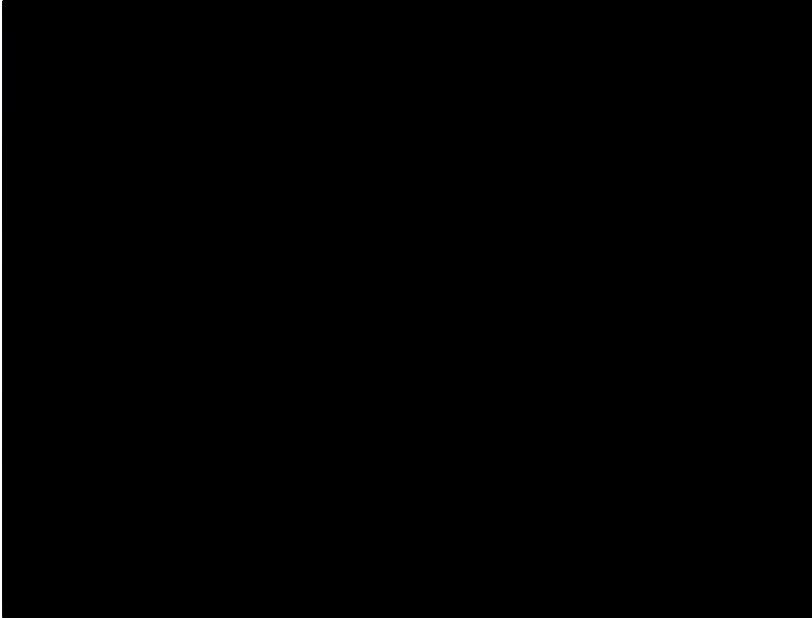

Photograph 1 – Garden of XX Plas Hen

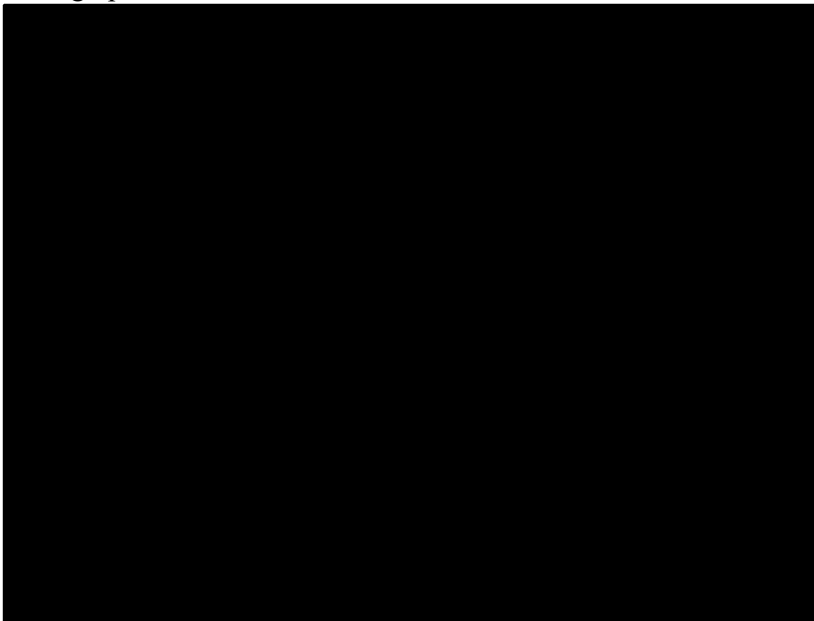

Photograph 2 – Front door of property



Photograph 3 – Overhanging trees by the highway gully  
Isle of Anglesey County Council, Llangefni, Anglesey. LL77 7TW





Photograph 4 – Estate road towards XX Stad Plas Hen